

Accessories for Workstation



Steel compartment with 5 levels capacity		
117342	W 330 x D 240 x H 295 mm / W 12.99 x D 9.45 x H 11.61 Inch	On stock



Steel binder holder with 3 compartments		
117340	W 240 x D 240 x H 295 mm / W 9.45 x D 9.45 x H 11.61 Inch	On stock

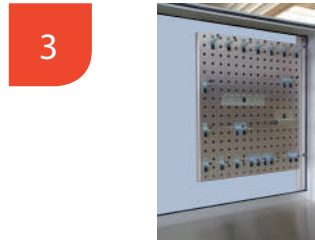

Adaptable perforated support W 550 x H 600 mm / W 21.65 x 23.62»		
601110	To be fixed with screws	On stock

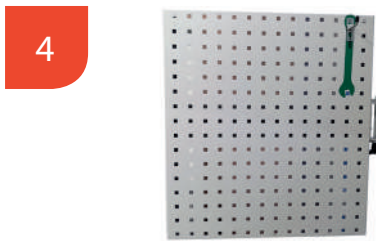

Adaptable perforated support W 550 x H 600 mm / W 21.65 x 23.62»		
601111	On swivel arm	On stock

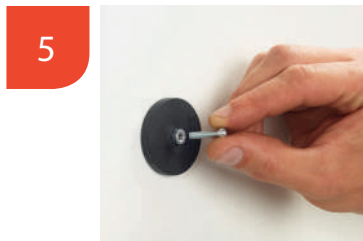

Magnetic tapping studs Ø 40 mm / 1.57" Th. 6 mm / 0.23"		
143201	Set of 3	On stock

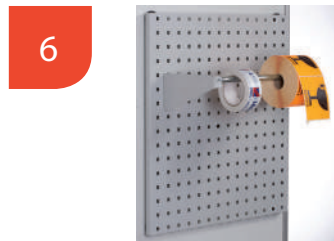

Roll dispenser		
604019	for perforated back	3 days

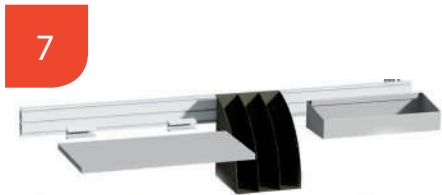

Multifunctional aluminium rail		
544006	W 556 mm / W 21.89 Inch	3 days
544009	W 900 mm / W 35.43 Inch	3 days
544010	W 800 mm / W 31.5 Inch	3 days
544011	W 1000 mm / W 39.37 Inch	3 days
544012	W 1200 mm / W 47.24 Inch	3 days
544013	W 1500 mm / W 59.06 Inch	3 days
544014	W 1800 mm / W 70.87 Inch	3 days
544015	W 2000 mm / W 78.74 Inch	3 days



Height-adjustable shelf W 450 x D 150 mm fixing on aluminium profile for cleaning products		
660140	l 450 x P 150 mm / W 17.72 x D 5.91 Inch	On stock



Side retractable shelf fixing on aluminium profile		
544058	W 620 x D 500 mm / W 24.41 x D 19.69 Inch	On stock